

# ProKure<sup>®</sup> V

## Preparation & Application



### WHY PROKURE V?

ProKure V, when used as directed, is an EPA registered, hospital type disinfectant, general purpose antimicrobial and surface cleaner. Spray the ClO<sub>2</sub> liquid directly onto surface being treated and allow to air dry.

It's ideal for disinfecting walls, floors, furniture, stainless steel, glass, vinyl, or other hard non-porous surfaces.



### TO PREPARE

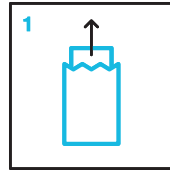

**Step 1:** Tear open the foil package and remove the white inner pouch. DO NOT OPEN WHITE INNER POUCH.

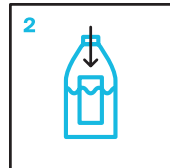

**Step 2:** Add the pouch to an opaque (not clear) ProKure container filled with the appropriate amount of water. (In most cases, drop the 0.84oz pouch in the dark ProKure V 5-gallon container filled with water.)

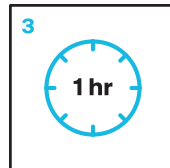

**Step 3:** Allow pouch to activate in water for one (1) hour to reach full strength.

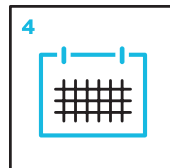

**Step 4:** Use stored formula within 15 days of activation.

### TO APPLY

**Step 1:** Visibly soiled surfaces must be pre-cleaned prior to treatment.

**Step 2:** ProKure V may be applied via mop, sprayer or sponge.

**Step 3:** Allow for 10 minutes of exposure at 100ppm for disinfection.

**Step 4:** Allow ProKure V to air dry. No wipe or rinse necessary.

**NOTE:** Read the EPA label to learn how to use ProKure V to eliminate mold and mildew.

### PROKURE & COVID-19

ProKure V has demonstrated effectiveness against viruses similar to SARS-CoV-2, the virus that causes COVID-19, on hard, non-porous surfaces. Therefore, ProKure V can be used against COVID-19 when used in accordance with the directions for use against Poliovirus-1 on hard, non-porous surfaces. Refer to the CDC website at [www.cdc.gov/coronavirus/2019-ncov/index.html](http://www.cdc.gov/coronavirus/2019-ncov/index.html) for additional information.

*This guide is not a replacement for the EPA label. It is a violation of Federal Law to use this product in a manner inconsistent with the labeling. Read the entire label and use strictly in accordance with precautionary statements and use.*